

STRUCTURAL
ENGINEERING
TECHNOLOGIES, P.C.

40-12 28TH Street, Long Island City, NY 11101
• (P) 718-706-7196 • (F) 718-472-4464 • (E) gjc@set-ny.com

GEORGE J. CAMBOURAKIS, P.E., C. ENG.

PRESIDENT & CHIEF STRUCTURAL ENGINEER

Professional Experience: Pride and Passion in the Art of Structural Engineering since 1979.

Professional Registration: Professional Engineer: Licensed in New York (# 060234) & New Jersey (#24GE03729700)

HIGHLIGHTS OF EXPERIENCE:

Mr. Cambourakis has over 39 years of experience in structural and foundation engineering. Much of this experience (from 1979-1989) has been with Thornton-Tomasetti, P.C. of New York City, one of the premier structural engineering consulting firms in the world.

Mr. Cambourakis started his own consulting practice in 1989, and has since found a niche in structural design of new buildings, foundation design, deep foundations and excavation support systems, drilled pile systems, structural rehabilitation and restoration of existing buildings, Landmarked buildings, building demolition, construction support services, civil/site work, and Peer Review services for the NYC Department of Buildings. This experience has included commercial, residential, hotel, institutional and industrial buildings from 3,000 square feet to over 1,000,000 square feet in size.

EDUCATION:

Bachelor of Engineering, Civil Engineering, City College of New York, 1979

Master of Engineering, Structural Engineering, City College of New York, 1983

Professional Degree (Ph.D. Candidate), Structural Engineering, Columbia University, New York, 1990

PROFESSIONAL ACTIVITIES:

- Professor for “Design of Reinforced Concrete Structures”, “Design of Steel Structures”, and “Statics and Strength of Materials” at Pratt Institute, Brooklyn, NY, Architectural Department since 1990
 - Professor for “Structures I” and “Structures II” at Pratt Institute, Construction Management Department, Manhattan Campus, since 2013
-

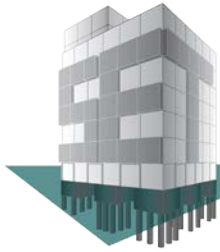

STRUCTURAL
ENGINEERING
TECHNOLOGIES, P.C.

40-12 28TH Street, Long Island City, NY 11101
• (P) 718-706-7196 • (F) 718-472-4464 • (E) gjc@set-ny.com

- Committee Member of Joint ADSC/DFI Micropile Committee
- American Society of Civil Engineers
- National Society of Professional Engineers
- American Institute of Steel Construction
- American Concrete Institute
- Deep Foundations Institute (DFI)
- ADSC : International Association of Foundation Drilling
- International Society for Micropiles (ISM)
- International Concrete Repair Institute